

ESCO TYPE TEETH AND ADAPTERS CATALOGUE

TEETHS

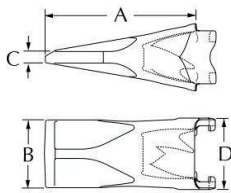

Part No	A	B	C	D	Weight
V17	135mm	51mm	6mm	65mm	1,2kg
V19	165mm	63mm	13mm	80mm	2,4kg
V23	190mm	76mm	13mm	90mm	3,1kg
V29	211mm	89mm	18mm	96mm	4,9kg
V33	231mm	102mm	21mm	108mm	6,8kg

ADAPTERS

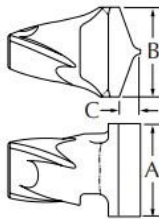

Part No	A	B	C	Weight
V17	61mm	63mm	17mm	2,4kg
V19	73mm	76mm	19mm	3,5kg
V23	89mm	89mm	21mm	5,8kg
V29	89mm	91mm	47mm	7,5kg
V33	102mm	103mm	25mm	11,5kg

PINS

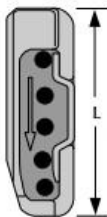

Part No	L	Weight
V17	48mm	0,05kg
V19	52mm	0,05kg
V23	52mm	0,05kg
V29	78mm	0,14kg
V33	86mm	0,14kg